

# Made to Order Common Specifications:

**-XC26** : Double Clevis Width 12.5 mm, 16.5 mm, 19.5 mm: With Double Clevis and Double Knuckle Joint



**33** Double Clevis Width 12.5 mm, 16.5 mm, 19.5 mm: With Double Clevis and Double Knuckle Joint **-XC26**

3 types of double clevis width and double knuckle joint width: 12.5 mm, 16.5 mm, 19.5 mm  
 Made to order -XC35, -XC88/-XC89, and -XC91 are available.

## Applicable Series

Series	Description	Model	Action	Bore size (mm)	Made to Order			Vol. no. (for std model)
					With coil scraper <b>XC35</b>	Spatter resistant specification for arc welding <b>XC88/XC89</b>	Spatter resistant specification for arc welding <b>XC91</b>	
<b>CQ2</b>	Standard	CQ2-Z	Double acting, Single rod	32, 40, 50, 63	○	○	○	<b>2</b> -1 From P. 773
	Long stroke	CQ2-Z			○	○	—	
	Anti-lateral load	CQ2 <input type="checkbox"/> S-Z	—		○	—		

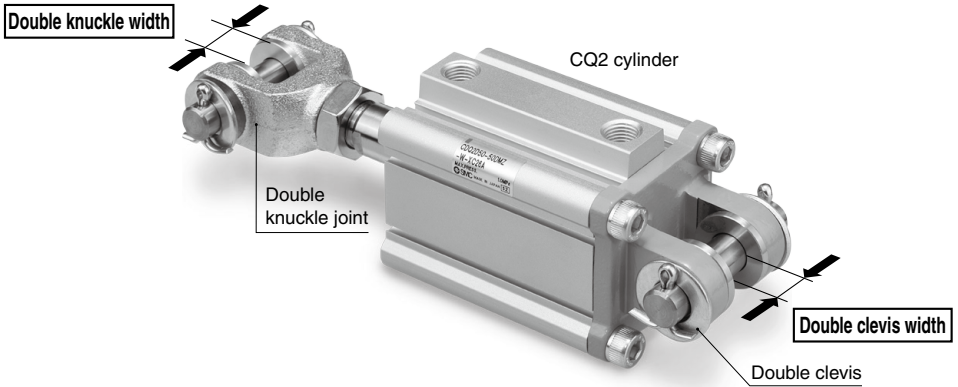

# Made to Order Common Specifications:

-XC26□: Double Clevis Width 12.5 mm, 16.5 mm, 19.5 mm: With Double Clevis and Double Knuckle Joint



**33** Double Clevis Width 12.5 mm, 16.5 mm, 19.5 mm: With Double Clevis and Double Knuckle Joint

CQ2 series: Standard

## How to Order

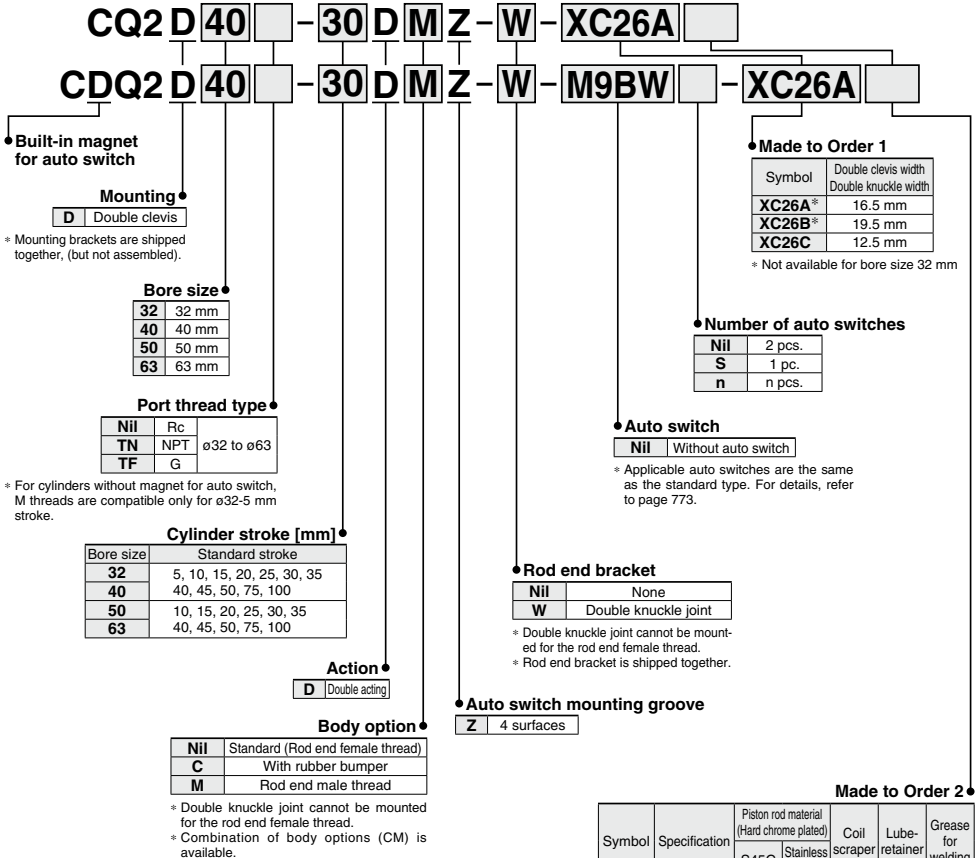

## Ordering Example of Cylinder Assembly

When arranging Made to Order 1 and 2 at the same time  
Cylinder model: CDQ2D40-30DMZ-W-M9BW-XC26AC35

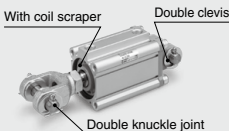

**Mounting** D: Double clevis  
**Rod end bracket W: Double knuckle joint**  
Made to Order 1 : XC26A  
(Double clevis/knuckle width: 16.5 mm)  
Made to Order 2 : XC35  
(With coil scraper)  
**Auto switch D-M9BW: 2 pcs.**

## Made to Order 2

Symbol	Specification	Piston rod material (Hard chrome plated)		Coil scraper	Lube- retainer	Grease for welding
		S45C	Stainless steel 304			
Nil	None	—	—	—	—	—
XC35	With coil scraper	●	—	●	—	—
XC88*	Spatter resistant spec. for arc welding	—	●	●	●	●
XC89*	Spatter resistant spec. for arc welding	●	—	●	●	●
XC91*	Spatter resistant spec. for arc welding	●	—	●	—	●

\* Only available for cylinders with built-in magnet for auto switch

Double Clevis Width  
Double Knuckle Width

Made to Order Common Specifications:  
12.5 mm, 16.5 mm, 19.5 mm: With Double Clevis and Double Knuckle Joint

Symbol

-XC26

Bore Size

Ø32 to Ø63 Standard

C(D)Q2D-XC26

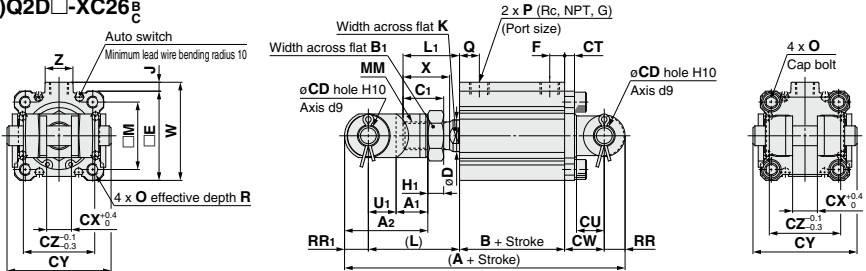

- Note 1) Intermediate strokes (1 to 99 mm) are available in 1 mm increments.  
For intermediate strokes, the dimensions are the same as a standard stroke one size larger than this intermediate stroke.
- Note 2) For 5 mm stroke with bore size 32 and without magnet for auto switch, F dimension is 5.5 and P dimension is M5 x 0.8.
- Note 3) For models with a rubber bumper, the stroke length tolerance does not include the deflection of the bumper.
- Note 4) Flat washers and split pins are included with the double clevis and double knuckle joint of this cylinder.
- Note 5) Double clevis and double knuckle joint are shipped together with the product.

Bore size	Stroke range	Without magnet for auto switch		Built-in magnet for auto switch		CD	CT	CU	CW	CX			CY	CZ	D	E	F	J
		A	B	A	B					XC26A	XC26B	XC26C						
32	50 or less	111	23	121	33	10	5	14	20	—	—	12.5	52.5	36	16	45	7.5	4.5
	75, 100	121	33															
40	50 or less	119.5	29.5	129.5	39.5	10	6	14	22	16.5	19.5	12.5	52.5	36	16	52	7.5	5
	75, 100	129.5	39.5															
50	50 or less	147.5	30.5	157.5	40.5	14	7	20	28	16.5	19.5	12.5	66	44	20	64	10.5	7
	75, 100	157.5	40.5															
63	50 or less	155	36	165	46	14	8	20	30	16.5	19.5	12.5	66	44	20	77	10.5	7
	75, 100	165	46															

Bore size	K	L	M	O	P	Q	R	RR	RR1	U1	W	Z	A1	A2	B1	C1	H1	L1	MM	X
32	14	46	34	M6 x 1.0	1/8	10	10	10	12	14	49.5	14	16	42	22	20.5	8	28.5	M14 x 1.5	23.5
40	14	46	40	M6 x 1.0	1/8	12.5	10	10	12	14	57	15	16	42	22	20.5	8	28.5	M14 x 1.5	23.5
50	17	59	50	M8 x 1.25	1/4	10.5	14	14	16	20	71	19	20	56	27	26	11	33.5	M18 x 1.5	28.5
63	17	59	60	M10 x 1.5	1/4	15	18	14	16	20	84	19	20	56	27	26	11	33.5	M18 x 1.5	28.5

Made to Order (Dimensions other than those shown below are the same as those shown above.)

■ With coil scraper:  
C(D)Q2D-XC26-C35

■ Spatter resistant specification for arc welding:  
CDQ2D-XC26-C88/C89/C91

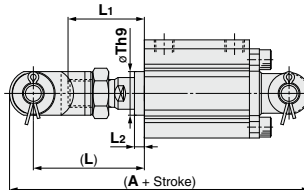

Bore size	Stroke range	XC35/XC91					XC88/XC89					
		Without magnet for auto switch		Built-in magnet for auto switch			Without magnet for auto switch		Built-in magnet for auto switch			
		A	L	L1	L2	Th9	A	L	L1	L2	Th9	
32	50 or less	116	126	51	33.5	5	23 <sup>0</sup> <sub>-0.052</sub>	131	56	38.5	10	23 <sup>0</sup> <sub>-0.052</sub>
	75, 100	126										
40	50 or less	124.5	134.5	51	33.5	5	28 <sup>0</sup> <sub>-0.052</sub>	139.5	56	38.5	10	28 <sup>0</sup> <sub>-0.052</sub>
	75, 100	134.5										
50	50 or less	152.5	162.5	64	38.5	5	35 <sup>0</sup> <sub>-0.062</sub>	167.5	69	43.5	10	35 <sup>0</sup> <sub>-0.062</sub>
	75, 100	162.5										
63	50 or less	160	170	64	38.5	5	35 <sup>0</sup> <sub>-0.062</sub>	175	69	43.5	10	35 <sup>0</sup> <sub>-0.062</sub>
	75, 100	170										

\* XC88, XC89 and XC91 are only available for cylinders with built-in magnet for auto switch.



# Made to Order Common Specifications:

-XC26□: Double Clevis Width 12.5 mm, 16.5 mm, 19.5 mm: With Double Clevis and Double Knuckle Joint



**33** Double Clevis Width 12.5 mm, 16.5 mm, 19.5 mm: With Double Clevis and Double Knuckle Joint

## CQ2 series: Long stroke

### How to Order

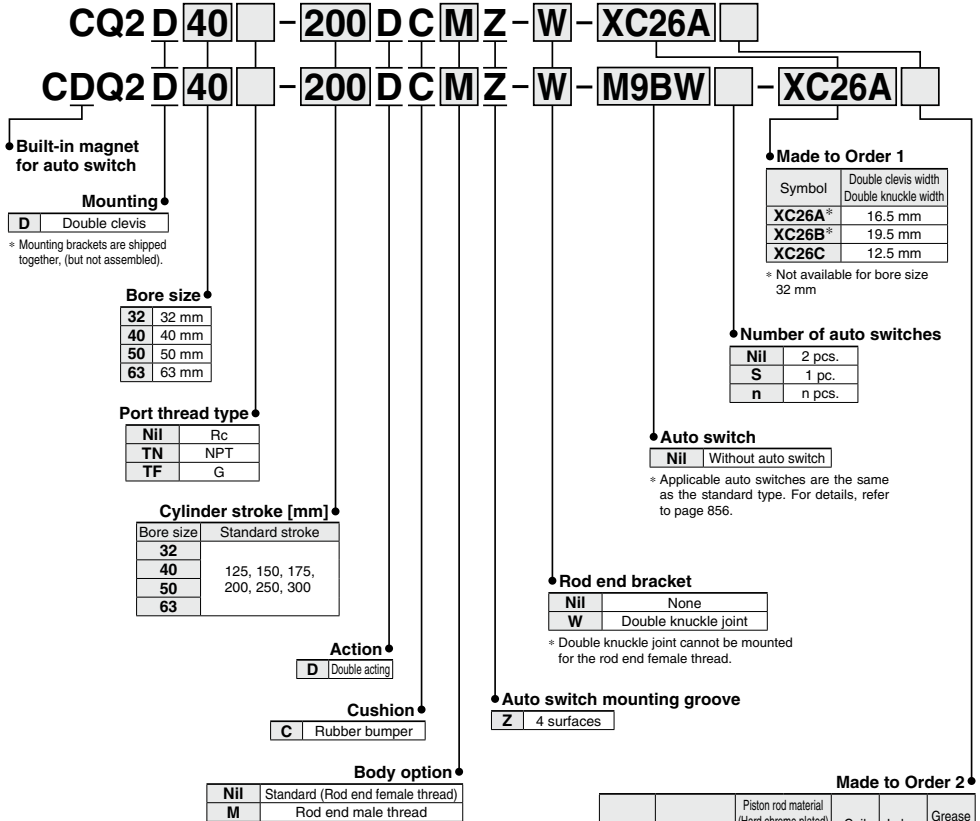

### Ordering Example of Cylinder Assembly

When arranging Made to Order 1 and 2 at the same time  
Cylinder model: CDQ2D40-200DCMZ-W-M9BW-XC26A35

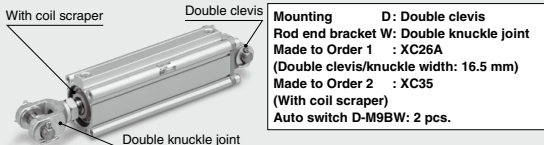

Symbol	Specification	Piston rod material (Hard chrome plated)		Coil scraper	Lube-retainer	Grease for welding
		S45C	Stainless steel 304			
Nil	None	—	—	—	—	—
XC35	With coil scraper	●	—	●	—	—
XC88*	Spatter resistant spec. for arc welding	—	●	●	●	●
XC89*	Spatter resistant spec. for arc welding	●	—	●	●	●

\* Only available for cylinders with built-in magnet for auto switch

Double Clevis Width  
Double Knuckle Width

**Made to Order Common Specifications:**  
12.5 mm, 16.5 mm, 19.5 mm: With Double Clevis and Double Knuckle Joint

Symbol

**-XC26**

Bore Size

**Ø32 to Ø63** Long Stroke

**C(D)Q2D**-XC26

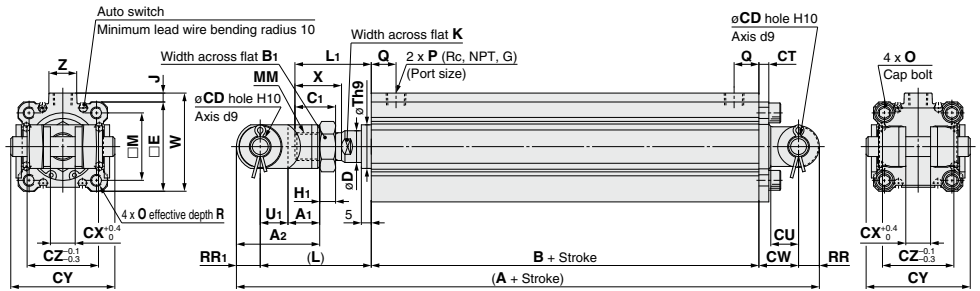

Note 1) Intermediate strokes (101 to 299 mm) are available in 1 mm increments.

For intermediate strokes, the dimensions are the same as a standard stroke one size larger than this intermediate stroke.

Note 2) Stroke length tolerance does not include the deflection of the bumper.

Note 3) Flat washers and split pins are included with the double clevis and double knuckle joint of this cylinder.

Note 4) Double clevis and double knuckle joint are shipped together with the product.

Bore size	Stroke range	A	B	CD	CT	CU	CW	CX			CY	CZ	D	E	J	K	L	M
								XC26A	XC26B	XC26C								
32		143.5	45.5	10	5	14	20	—	—	12.5	52.5	36	16	45	4.5	14	56	34
40	125, 150, 175,	155	55	10	6	14	22	16.5	19.5	12.5	52.5	36	16	52	5	14	56	40
50	200, 250, 300	182.5	55.5	14	7	20	28	16.5	19.5	12.5	66	44	20	64	7	17	69	50
63		186	57	14	8	20	30	16.5	19.5	12.5	66	44	20	77	7	17	69	60

  

Bore size	O	P	Q	R	RR	RR1	Th9	U1	W	Z	A1	A2	B1	C1	H1	L1	MM	X
32	M6 x 1.0	1/8	10	10	10	12	22 <sup>0.052</sup>	14	49.5	14	16	42	22	20.5	8	38.5	M14 x 1.5	23.5
40	M6 x 1.0	1/8	12.5	10	10	12	28 <sup>0.052</sup>	14	57	15	16	42	22	20.5	8	38.5	M14 x 1.5	23.5
50	M8 x 1.25	1/4	14	14	14	16	35 <sup>0.062</sup>	20	71	19	20	56	27	26	11	43.5	M18 x 1.5	28.5
63	M10 x 1.5	1/4	16.5	18	14	16	35 <sup>0.062</sup>	20	84	19	20	56	27	26	11	43.5	M18 x 1.5	28.5

**Made to Order** (Dimensions other than those shown below are the same as those shown above.)

■With coil scraper: C(D)Q2D-CX26-C35

■Spatter resistant specification for arc welding: CDQ2D-CX26-C88/C89

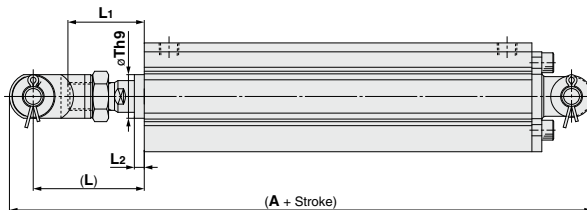

Bore size	Stroke range	XC35					XC88/XC89				
		A	L	L1	L2	Th9	A	L	L1	L2	Th9
32		143.5	56	38.5	5	23 <sup>0.052</sup>	148.5	56	38.5	10	23 <sup>0.052</sup>
40	125, 150, 175,	155	56	38.5	5	28 <sup>0.052</sup>	160	56	38.5	10	28 <sup>0.052</sup>
50	200, 250, 300	182.5	69	43.5	5	35 <sup>0.062</sup>	187.5	69	43.5	10	35 <sup>0.062</sup>
63		186	69	43.5	5	35 <sup>0.062</sup>	191	69	43.5	10	35 <sup>0.062</sup>

\* XC88 and XC89 are only available for cylinders with built-in magnet for auto switch.

# Made to Order Common Specifications:

-XC26□: Double Clevis Width 12.5 mm, 16.5 mm, 19.5 mm: With Double Clevis and Double Knuckle Joint



**33** Double Clevis Width 12.5 mm, 16.5 mm, 19.5 mm: With Double Clevis and Double Knuckle Joint

CQ2□S series: Anti-lateral load

## How to Order

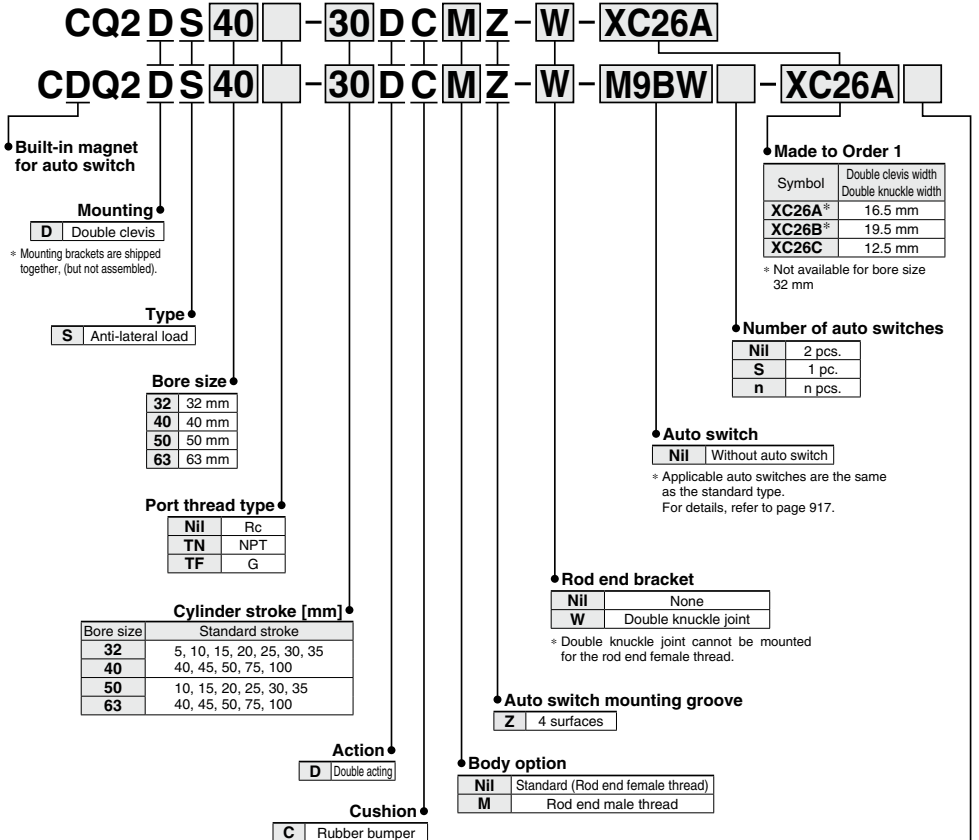

## Ordering Example of Cylinder Assembly

When arranging Made to Order 1 and 2 at the same time  
Cylinder model: CDQ2DS40-30DCMZ-W-M9BW-XC26AC89

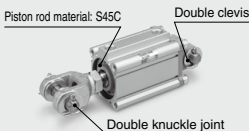

**Mounting** **D**: Double clevis  
**Rod end bracket W**: Double knuckle joint  
Made to Order 1 : XC26A  
(Double clevis/knuckle width: 16.5 mm)  
Made to Order 2 : XC89  
(Piston rod material: S45C)  
Auto switch D-M9BW: 2 pcs.

## Made to Order 2

Symbol	Specification	Piston rod material (Hard chrome plated)		Coil scraper	Lube- retainer	Grease for welding
		S45C	Stainless steel 304			
Nil	None	—	—	—	—	—
XC88*	Spatter resistant spec. for arc welding	—	●	●	●	●
XC89*	Spatter resistant spec. for arc welding	●	—	●	●	●

\* Only available for cylinders with built-in magnet for auto switch

Double Clevis Width  
Double Knuckle Width

12.5 mm, 16.5 mm, 19.5 mm: With Double Clevis and Double Knuckle Joint

Made to Order Common Specifications:

Symbol

-XC26

Bore Size

Ø32 to Ø63 Anti-lateral Load

C(D)Q2DS-XC26

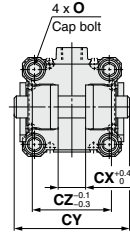
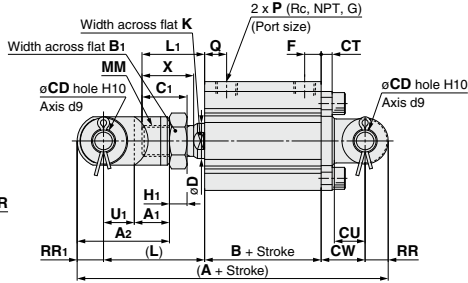
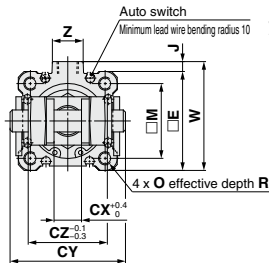

Note 1) Intermediate strokes (1 to 99 mm) are available in 1 mm increments.

For intermediate strokes, the dimensions are the same as a standard stroke one size larger than this intermediate stroke.

Note 2) Stroke length tolerance does not include the deflection of the bumper.

Note 3) Flat washers and split pins are included with the double clevis and double knuckle joint of this cylinder.

Note 4) Double clevis and double knuckle joint are shipped together with the product.

Bore size	Stroke range	Without magnet for auto switch		Built-in magnet for auto switch		CD	CT	CU	CW	CX			CY	CZ	D	E	F	J
		A	B	A	B					XC26A	XC26B	XC26C						
32	50 or less	121	33	131	43	10	5	14	20	—	—	12.5	52.5	36	16	45	7.5	4.5
	75, 100	131	43															
40	50 or less	129.5	39.5	139.5	49.5	10	6	14	22	16.5	19.5	12.5	52.5	36	16	52	7.5	5
	75, 100	139.5	49.5															
50	50 or less	157.5	40.5	167.5	50.5	14	7	20	28	16.5	19.5	12.5	66	44	20	64	10.5	7
	75, 100	167.5	50.5															
63	50 or less	165	46	175	56	14	8	20	30	16.5	19.5	12.5	66	44	20	77	10.5	7
	75, 100	175	56															

Bore size	K	L	M	O	P	Q	R	RR	RR1	U1	W	Z	A1	A2	B1	C1	H1	L1	MM	X
32	14	46	34	M6 x 1.0	1/8	10	10	10	12	14	49.5	14	16	42	22	20.5	8	28.5	M14 x 1.5	23.5
40	14	46	40	M6 x 1.0	1/8	12.5	10	10	12	14	57	15	16	42	22	20.5	8	28.5	M14 x 1.5	23.5
50	17	59	50	M8 x 1.25	1/4	10.5	14	14	16	20	71	19	20	56	27	26	11	33.5	M18 x 1.5	28.5
63	17	59	60	M10 x 1.5	1/4	15	18	14	16	20	84	19	20	56	27	26	11	33.5	M18 x 1.5	28.5

Made to Order (Dimensions other than those shown below are the same as those shown above.)

■Spatter resistant specification for arc welding: CDQ2DS-XC26 C88/C89

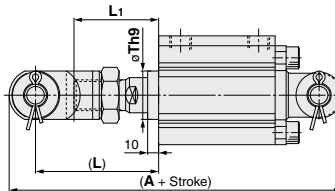

Bore size	Stroke range	XC88/XC89			
		A	L	L1	Th9
32	5, 10, 15, 20, 25, 30,	141	56	38.5	23.0 <sup>0.052</sup>
40	35, 40, 45, 50, 75, 100	149.5	56	38.5	28.0 <sup>0.052</sup>
50	10, 15, 20, 25, 30, 35,	177.5	69	43.5	35.0 <sup>0.052</sup>
63	40, 45, 50, 75, 100	185	69	43.5	35.0 <sup>0.052</sup>



# Made to Order Common Specifications:

**-XC26** Double Clevis Width 12.5 mm, 16.5 mm, 19.5 mm: With Double Clevis and Double Knuckle Joint



**33** Double Clevis Width 12.5 mm, 16.5 mm, 19.5 mm: With Double Clevis and Double Knuckle Joint **-XC26**

## Accessories

### Double knuckle joint

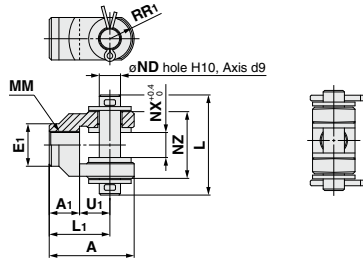

Part no.	Applicable bore size	A	A1	E1	L1	MM	RR1	U1	ND	NX	NZ	L
Y-G04-XC26A	32, 40	42	16	ø22	30	M14 x 1.5	12	14	10	16.5	36	52.5
Y-G04-XC26B										19.5		
Y-G04-XC26C										12.5		
Y-G05-XC26A	50, 63	56	20	ø28	40	M18 x 1.5	16	20	14	16.5	44	66
Y-G05-XC26B										19.5		
Y-G05-XC26C										12.5		

Note) A knuckle joint pin, 2 flat washers and 2 split pins are included.

### Double clevis

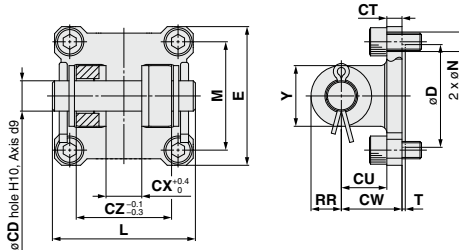

Part no.	Applicable bore size	D	E	M	N	T	CD	CT	CU	CW	CX	CZ	RR	L	Y
CQ-D032-XC26C	32	30.7	45	34	6.6	1	10	5	14	20	12.5	36	10	52.5	20
CQ-D040-XC26A											16.5				
CQ-D040-XC26B	40	39.1	52	40	6.6	1	10	6	14	22	16.5	36	10	52.5	20
CQ-D040-XC26C											19.5				
CQ-D050-XC26A											12.5				
CQ-D050-XC26A	50	48.5	64	50	9	1.5	14	7	20	28	16.5	44	14	66	28
CQ-D050-XC26B											19.5				
CQ-D050-XC26C											12.5				
CQ-D063-XC26A	63	61.3	77	60	11	2	14	8	20	30	16.5	44	14	66	28
CQ-D063-XC26B											19.5				
CQ-D063-XC26C											12.5				

Note) A clevis pin, 2 flat washers, 2 split pins and 4 hexagon socket head cap screws are included.