

## Precision Regulator with Handle Cover

SMC CORPORATION  
1-16-4 Shimbashi, Minato-ku  
Tokyo 105-0004, JAPAN  
URL: <http://www.smcworld.com>

**IR20\*0-\*\*\*-DIH00498 、 IR30\*0-\*\*\*-DIH00499**

---

**Feature: A Handle cover is attached the pressure regulator handle to prevent an inadvertent operation.**

The handle cover has a lock cover with a key mounting hole.

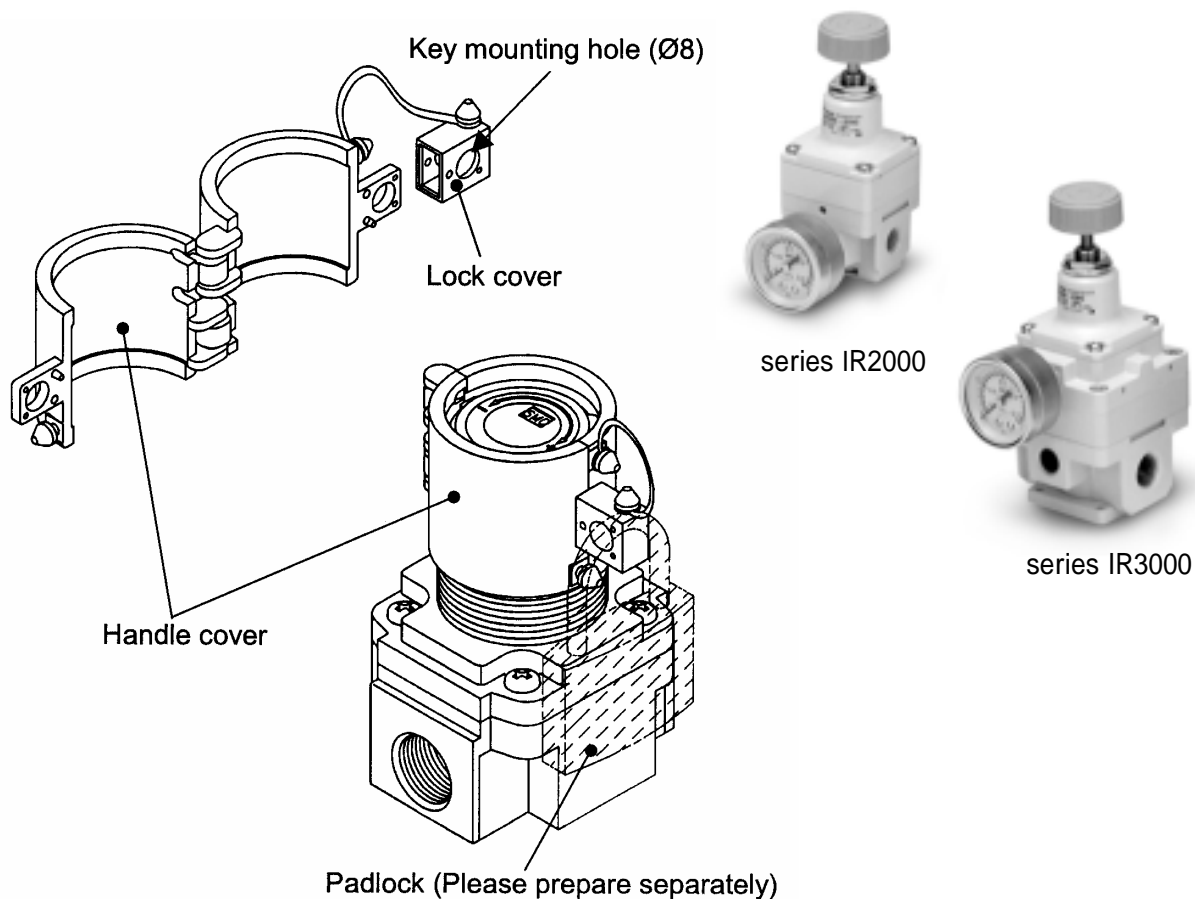

### Comparison with standard products

---

The handle cover (incl. the handle holder) is added. The precision regulator's body is the same as the standard IR series.

## Specifications (same as those of standard IR)

Model	IR20*0-***-DIH00498	IR30*0-***-DIH00499
Fluid	Air	
Max. supply pressure	1.0 MPa	
Min. supply pressure	Set pressure+0.05MPa	Set pressure+0.1MPa
Regulating pressure range	IR2000 : 0.005 ~ 0.2MPa	IR3000 : 0.005 ~ 0.2MPa
	IR2010 : 0.01 ~ 0.4MPa	IR3010 : 0.01 ~ 0.4MPa
	IR2020 : 0.01 ~ 0.8MPa	IR3020 : 0.01 ~ 0.8MPa
Sensitivity	Within 0.2% of full span	
Repeatability	Within 0.5% of full span	
Air consumption	3.0 L / min(ANR) or less ... supply pressure 0.7MPa 4.0 L / min(ANR) or less ... supply pressure 1.0MPa	
Ambient and fluid temperature	- 5 to 60°C (with no freezing)	
Port size	Rc1/4	Rc1/4, 3/8, 1/2
Pressure gauge port	Rc1/8 (2 locations)	
Weight	0.30 kg	0.64 kg

## How to Order

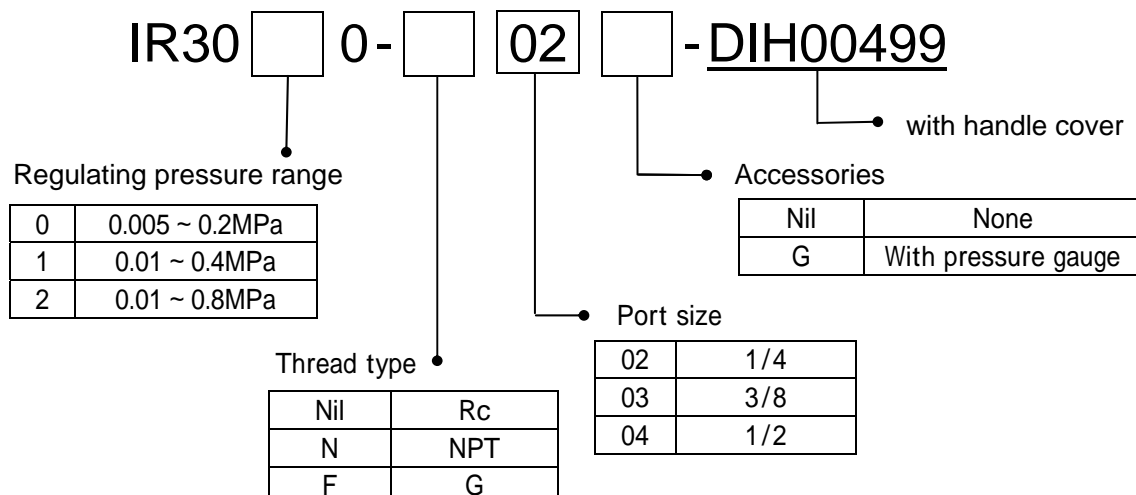
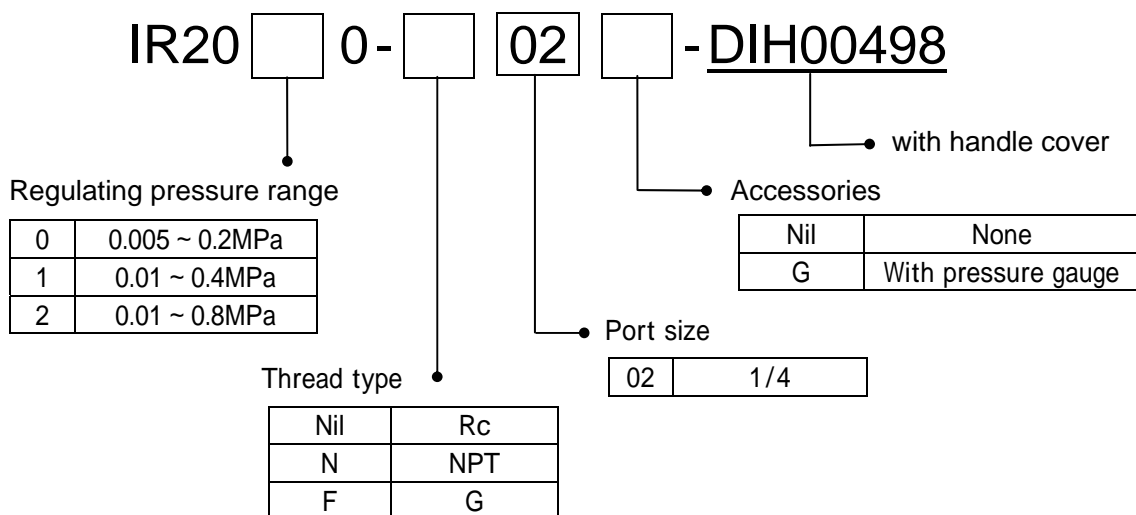

IR20\*0

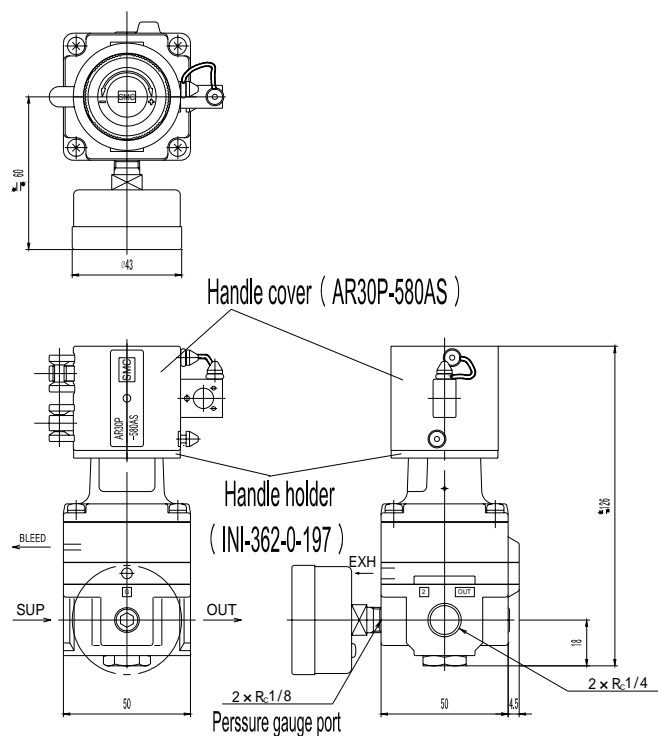

IR30\*0

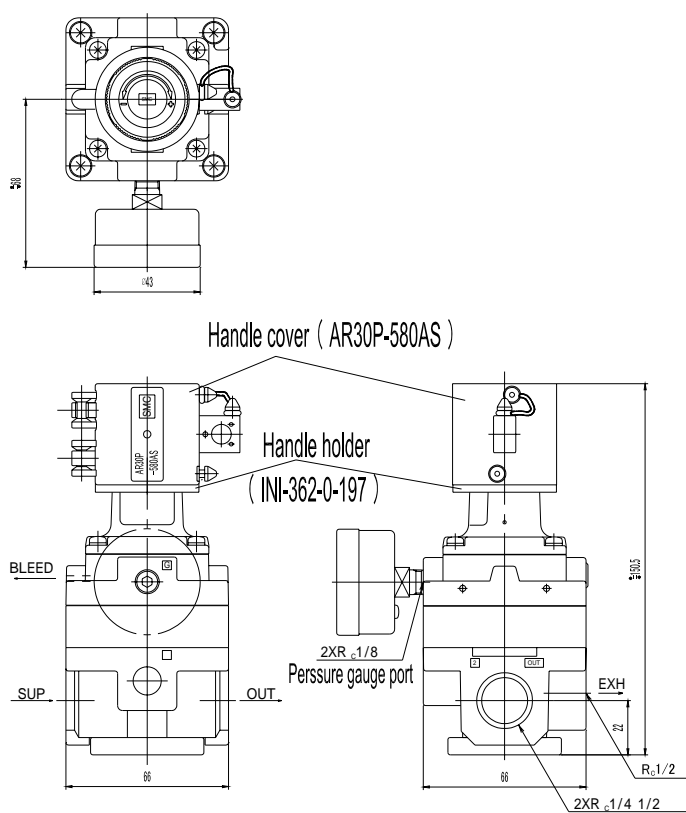

 **Caution:** To ensure the safest possible operation of this product, please be sure to read thoroughly the “Safety Instructions” in our “Best Pneumatics” general catalog before use.